

**Brading Road, Brixton, SW2**

2 bedroom flat to let

£440 Per Week

Furnished

Property Details

We are pleased to offer to the rental market this spacious two double bedroom flat to the lettings market, the flat comprises two large double bedrooms, a modern bathroom shared by both bedrooms. There is also a bright open plan kitchen which has access to your own private balcony perfect for entertaining guests throughout the summer months. The property is located just a short walk from Brockwell Park known to be one of the most famous green areas in South west London surrounded by pubs and cafes. Herne Hill Station is also within walking distance giving you great travel links into the city.

Features

- Conversion Flat
- Victorian
- 2 Bedrooms
- 1 Reception
- 1 Bathroom
- Bright And Airy Throughout
- Close To Transport Links
- Close to Brockwell Park

Council tax band C EPC rating C (71)



Brading Road

K

2 Bed flat

Approx internal area:

547 sqft 51 sqm

While we do try our very best, floor plans are produced as a guide only and we take no responsibility for the precise accuracy with which any property is represented

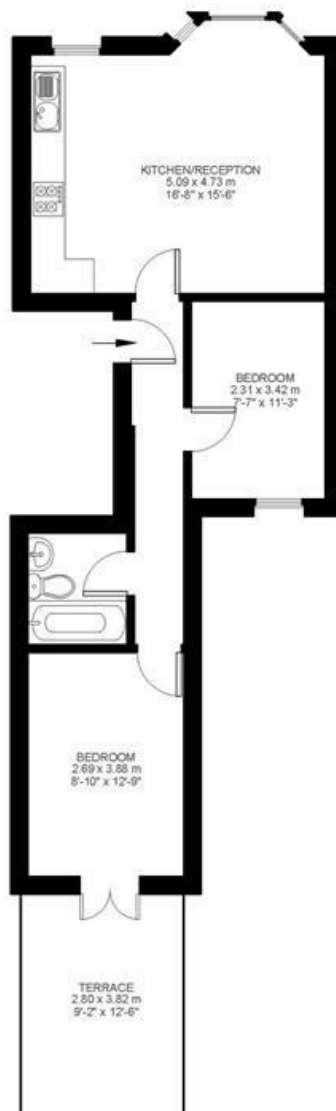

First Floor



Brading Road, Brixton, SW2

