

**Endymion Road, Brixton, SW2**

2 bedroom flat to let

£432 Per Week

Part furnished

Property Details

A fantastic two double bedroom split level flat located a short walk from the greenery of Brockwell Park. The flat comprises a spacious open plan kitchen and living area filled with natural light through large windows and skylights, two double bedrooms and a modern family size bathroom. The property is ideally located just a short walk away from Brixton where you will find a huge choice of pubs, bars, and restaurants. Less than a 10-minute walk away is the ever so popular Brockwell Park which offers an amazing view of London, a mini railway track, sporting facilities and much more.

Features

- Victorian
- Conversion flat
- Two double bedrooms
- One reception
- Family sized bathroom
- Close to Brockwell Park
- Close to transport links

Council tax band C EPC rating C (74)



Endymion Road, Brixton, SW2



2 bed flat.

Approx internal area:

581 sqft 54 sqm

Area excludes cellar.

While we do try our very best, floor plans are produced as a guide only and we take no responsibility for the precise accuracy with which any property is represented

Second Floor

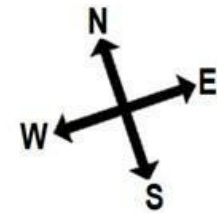

First Floor

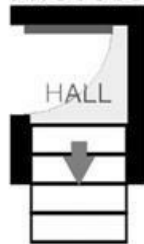

Endymion Road

Endymion Road, Brixton, SW2

