



Hubert Grove, Clapham, SW9

2 bedroom flat - conversion for sale

£575,000

Leasehold

Property Details

An appealing two double bedroom apartment with a private South-facing garden. Set within an end-of-terrace Victorian property. A complete blank canvas, the apartment is ready to move into straight away yet with the potential to add your own decorative touches over time. Precedent has been set should the purchaser wish to seek the necessary permissions to extend into the side return in the future. This lovely home has two well-proportioned double bedrooms, one with a large bay window, flooding the room with light particularly given the positioning looking down the street. The second bedroom has views into the side return of the garden. The bathroom separates the bedrooms allowing privacy for each, ideal for sharers. The generous proportions of the reception room allows ample space for a separate living room area, a dining space and an already semi-separated kitchen. French doors from both the reception and kitchen allow a transition out to the low-maintenance private garden. South-facing this suntrap is ideal for whiling away the summer months, with the added perk of a side gate, ideal for hosing BBQS or those with prams or bikes.

Council tax band C EPC rating D (63)

Features

- Two double bedrooms
- South-facing private garden
- Victorian end-of-terrace conversion
- Potential to extend STNP
- Neutrally presented throughout
- Clapham High street and the Northern Line an eight-minute walk
- Brixton a fifteen-minute walk
- Wide array of amenities
- Chain-free
- A share of the freehold will be granted



Hubert Grove, Clapham, SW9

Hubert Grove, SW9
2 Bedroom Flat

APPROXIMATE GROSS INTERNAL AREA: 650 SQ FT / 60 SQ M

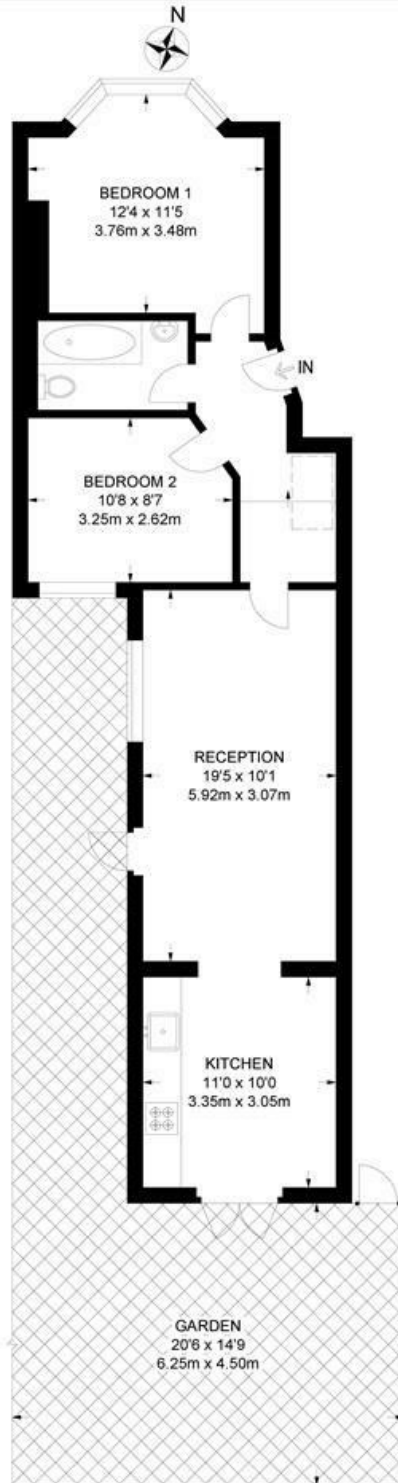

GROUND FLOOR



While we try our very best, floor plans are produced as a guide only and we take no responsibility for the precise accuracy with which any property is represented.

Hubert Grove, Clapham, SW9

