**Kellett Road, Brixton, SW2**

1 bedroom flat - conversion for sale

£375,000

Share of Freehold

Property Details

A bright one double bedroom flat in an attractive end-of terrace Victorian property on one of Brixton's most popular streets sandwiched between central Brixton, Herne Hill and Brockwell Park. The property is situated in moments away from the fashionable bars, restaurants and cafés of Brixton Village and Pop Brixton, as well the start of the Victoria Line. The semi-open plan reception room at the front of the property is perfectly formed with high ceilings and plenty of natural light thanks to a bright bay window stretching almost floor to ceiling. With generous proportions in which to lounge and dine this heart of the home is sure to become a cherished space. The charming country-style kitchen has plentiful storage, wrapping around to offer generous wooden surface space. The double bedroom is bright and tucked away quietly to the rear of the home, with plush carpets and a large window that overlooks the peaceful neighbouring gardens at the rear. Last but not least there is a luxurious bathroom with stylish tiling and a double-ended bathtub with overhead shower. All in all, a lovely apartment in a highly desirable location.

Features

- One double bedroom
- Victorian conversion
- End-of-terrace
- Tastefully decorated throughout
- Bright and airy
- Popular residential street
- Central Brixton moments away
- Brixton tube station a six-minute stroll
- Brockwell Park a ten-minute walk
- Share of freehold

Council tax band C **EPC rating C (72)**



Kellett Road, Brixton, SW2

Kellett Road, SW2
1 Bedroom Flat

APPROXIMATE GROSS INTERNAL AREA: **423 SQ FT / 39.3 SQ M**

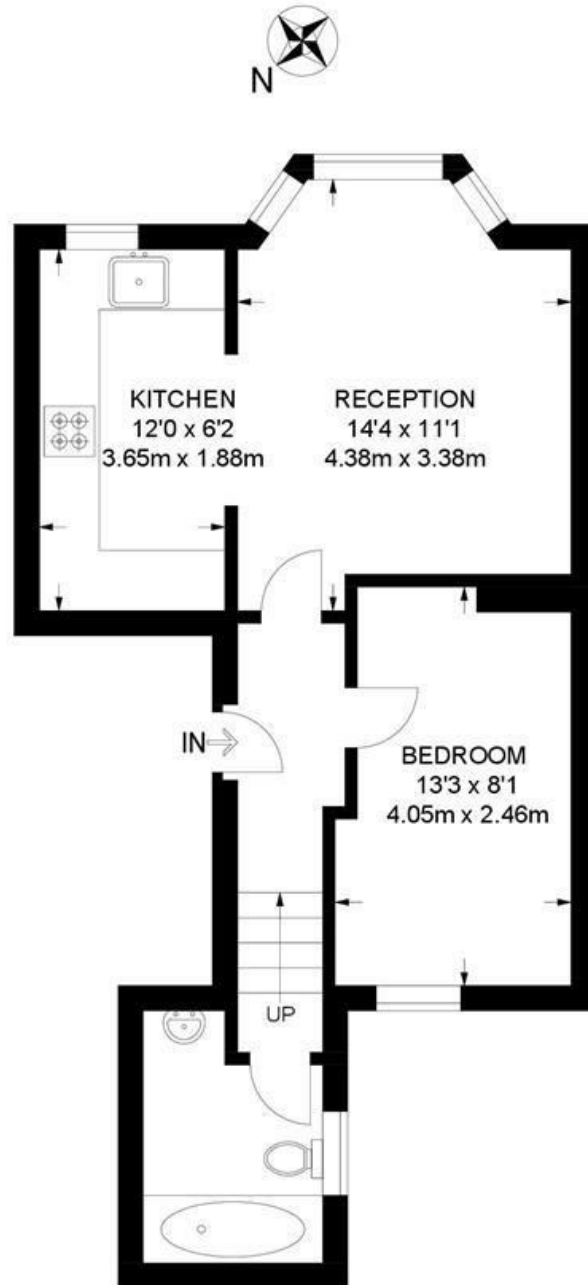

FIRST FLOOR



While we try our very best, floor plans are produced as a guide only and we take no responsibility for the precise accuracy with which any property is represented.

Kellett Road, Brixton, SW2

