

Endymion Road, Brixton, SW2

2 bedroom flat for sale

£675,000

Share of Freehold

Property Details

A beautiful two bedroom Victorian garden flat in a semi-detached house on a peaceful street with a parade of local shops and cafes moments away. A bright and airy reception has charming features including a working fireplace. The living space flows seamlessly through wooden double doors and into a spacious kitchen diner, allowing the two spaces to be separated when a cosier feel is desired, ideal for curling up in front of a winter fire. The kitchen is complete with sleek, modern cabinetry, topped with recently fitted new worktops. The generous proportions allow plenty of space for a dining table or an island, a lovely space in which to host with garden access via the un-extended side-return. Beautifully landscaped the private garden is low maintenance, has two tiers, outdoor lighting and planters including your own lime and palm trees! The two double bedrooms are quietly tucked at the rear. The principle has the luxury of an ensuite WC and double doors to the garden, creating a lovely setting for a morning coffee or nightcap under the stars. The second bedroom has a lovely bay window, set next to the main bathroom with a walk-in shower. There is a cellar, new front windows and Hive thermostat.

Council tax band C EPC rating (0)

Features

- Two double bedrooms
- Two bathrooms
- Private garden
- Semi-detached Victorian conversion
- Working fireplace
- Characterful features
- Local parade of shops and cafes moments away
- Sought after street in the LTN
- Short walk to Brockwell Park and central Brixton
- Share of freehold





Endymion Road, Brixton, SW2

Endymion Road, SW2
2 Bedroom Flat

APPROXIMATE GROSS INTERNAL AREA: 762 SQ FT / 71 SQ M

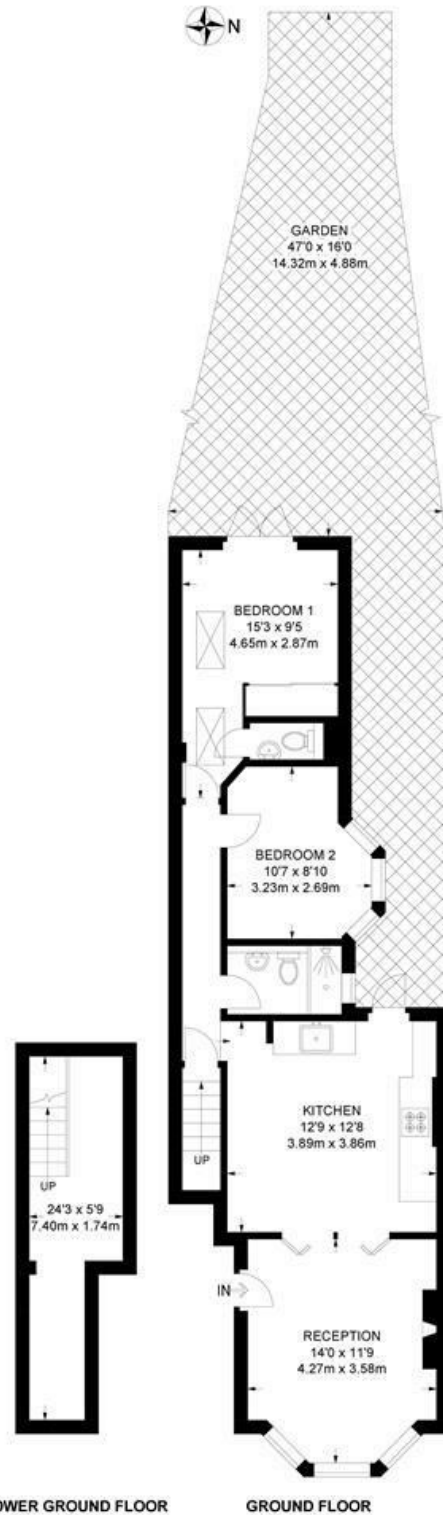

While we try our very best, floor plans are produced as a guide only and we take no responsibility for the precise accuracy with which any property is represented.

Endymion Road, Brixton, SW2

