

**New Park Road, SW2**

1 bedroom flat to let

£346 Per Week

Furnished

Property Details

This one double bedroom flat has incredible views from the shared roof terrace at the top of Brixton Hill. Tenants will have the benefit of Brixton town centre a fifteen minute walk away and has excellent bus links into the city. The flat has good dimensions and comprises a comfortable double bedroom with a walk-in closet, a modern bathroom and an open plan reception room with space to dine and relax. The property is in great condition, ideal for a young couple or single professional. The flat also comes with an allocated, off-street gated parking space. Brockwell Park is also within a ten minute walk, and Streatham Hill station, with direct trains to Clapham Junction and Victoria, is a similar distance.

Council tax band C EPC rating D (62)

Features

- One double bedroom
- Open Plan
- Excellent bus links into the city
- Fantastic views
- Communal roof terrace
- Gated, allocated parking space



New Park Road, SW2

New Park Road, Brixton, SW2

1 Bedroom Flat

Approximate internal area: **514 sqft 48 sqm**

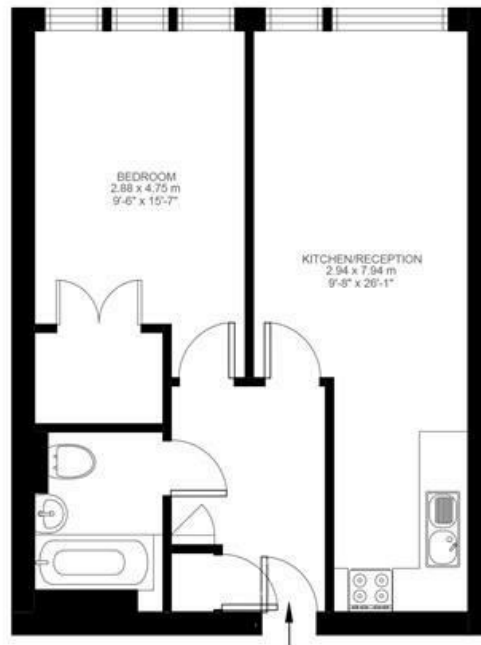

Ground Floor



While we do try our very best, floor plans are produced as a guide only and we take no responsibility for the precise accuracy with which any property is represented.

New Park Road, SW2

