



Loughborough Park, Brixton, SW9

2 bedroom flat - purpose built for sale

£550,000

Leasehold

Property Details

A fantastic two double bedroom, two bathroom apartment with a private terrace enjoying summer sunsets and city landmark views. Set on the seventh floor of a secure modern development with intercom entry, CCTV, and a lift, the location is ideal. Abundant natural light pours through expansive, energy-efficient windows, enhancing the property's excellent insulation for year-round comfort and reduced energy costs. The heart of the home is the spacious open-plan reception, bathed in natural light from floor-to-ceiling glass doors leading to the private terrace—perfect for unwinding, entertaining, or dining al fresco with breathtaking views of the London Eye, Vauxhall, Battersea Power Station, and Brockwell Park. The sleek, contemporary kitchen offers integrated appliances, gloss cabinetry, and ample storage. Both bedrooms are generous doubles, with the principal featuring built-in storage and an elegant ensuite. The second bedroom is versatile as a guest room, nursery, or office. A stylish main bathroom offers a peaceful retreat for relaxation with a bathtub and the copious hallway storage completes this stunning home.

Features

- Two double bedrooms
- Two bathrooms
- Private terrace with sunset and city views from the seventh floor
- Secure modern build
- Communal lawns, bike store, playground, basketball court
- Bright and airy
- Moments from central Brixton
- Short walk to Brockwell Park and Herne Hill
- Excellent transport links including Victoria Line, Thames Link and Trains

Council tax band D EPC rating B (86)



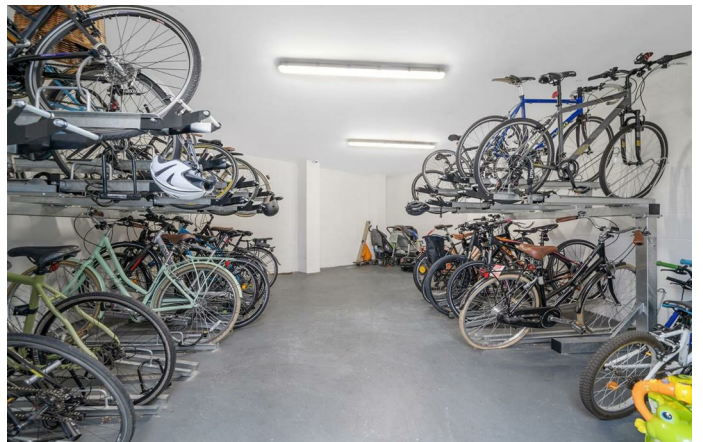

Loughborough Park, Brixton, SW9

Loughborough Park, SW9
2 Bedroom Flat

APPROXIMATE GROSS INTERNAL AREA: **797 SQ FT / 74 SQ M**

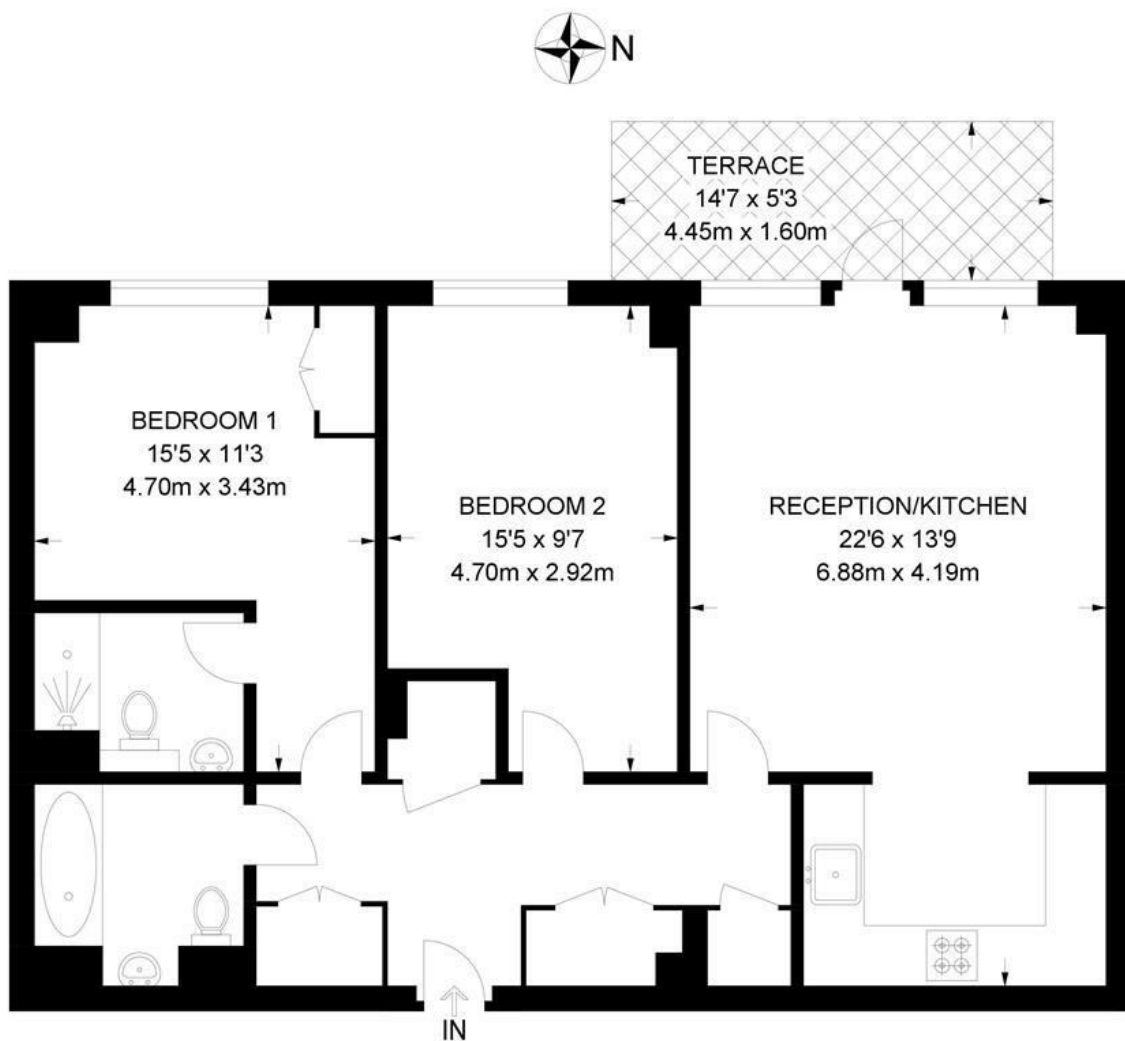

SEVENTH FLOOR



While we try our very best, floor plans are produced as a guide only and we take no responsibility for the precise accuracy with which any property is represented.

Loughborough Park, Brixton, SW9

