



Beechdale Road, Brixton, SW2

3 bedroom flat to let

£600 Per Week

Furnished

Property Details

This three bedroom ground floor flat has a beautiful patio garden and is tucked away just off Brixton Hill. You are spoilt for choice when it comes to transport links into the city including Brixton underground and overground stations, as well as the many bus routes that service the area. This flat consists of a spacious semi open plan lounge leading through to the kitchen that has doors opening onto the paved patio garden. To the front of the property you have three spacious double bedrooms and a good sized family bathroom.

Features

- Three bed
- Victorian
- Excellent transport links
- Private garden
- Close to Central Brixton

Council tax band D EPC rating C (69)



Beechdale Road, Brixton, SW2

Beechdale Road, SW2

Approximate Gross Internal Area
66.6 sq m / 717 sq ft

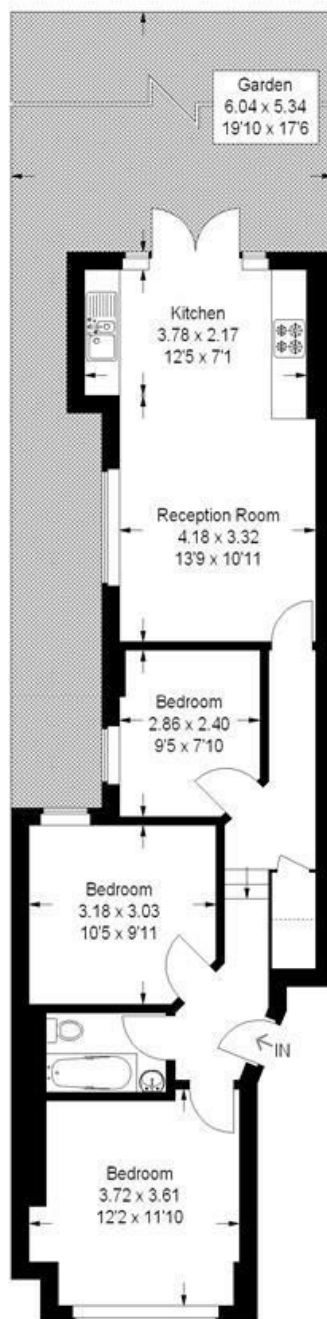

Ground Floor

This plan is for layout guidance only. Not drawn to scale unless stated. Windows and door openings are approximate. Whilst every care is taken in the preparation of this plan, please check all dimensions, shapes and compass bearings before making any decisions reliant upon them. (ID154883)

Beechdale Road, Brixton, SW2

